

SURVEY UNIT,

MINISTRY OF HOUSING AND ENVIRONMENT
Ameenee Magu, Maafannu, Male', 20392, Maldives.
Office (PABX): +(960) 3004300, Fax: +(960) 3004301
Email: survey@mhe.gov.mv
Web: www.mhe.gov.mv



CONTROL POINT DETAILS	Station Number PSM5025
Coordinate Information	
Geodetic	Grid
WGS 84	UTM Zone 43
Lat:	E: 258081.549 m
Long:	N: 403923.794 m
Ellp Height:	Orth Height: + 1.879 m
Date: 05/06/2012	

Monument description & method of survey:

Type A monument above ground, Closed Loop Traverse Method using coordinates.

General site condition & access:

Good access, in South West side of Island, between jetty No:2 and diving school (in front of sea sports shed)

Owner: Angaga Island resort and Spa



SITE INFORMATION

Station Number

P	S	M	5	0	2	5
---	---	---	---	---	---	---

Station Horizon Mask

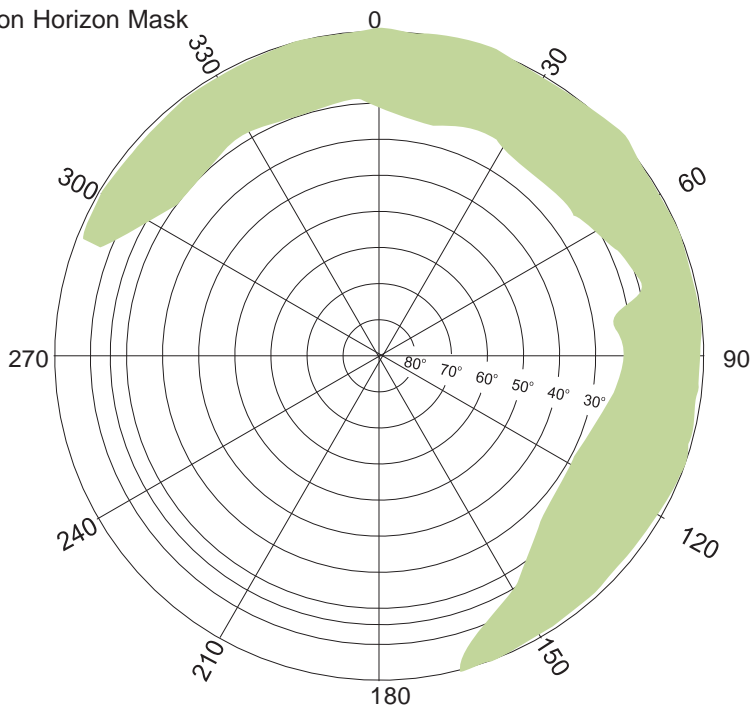

Height above Marker that horizon was mapped from 1.45 m

Magnetic Declination -----
 Declination applied to this figure?
 Yes No

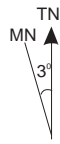

Locality

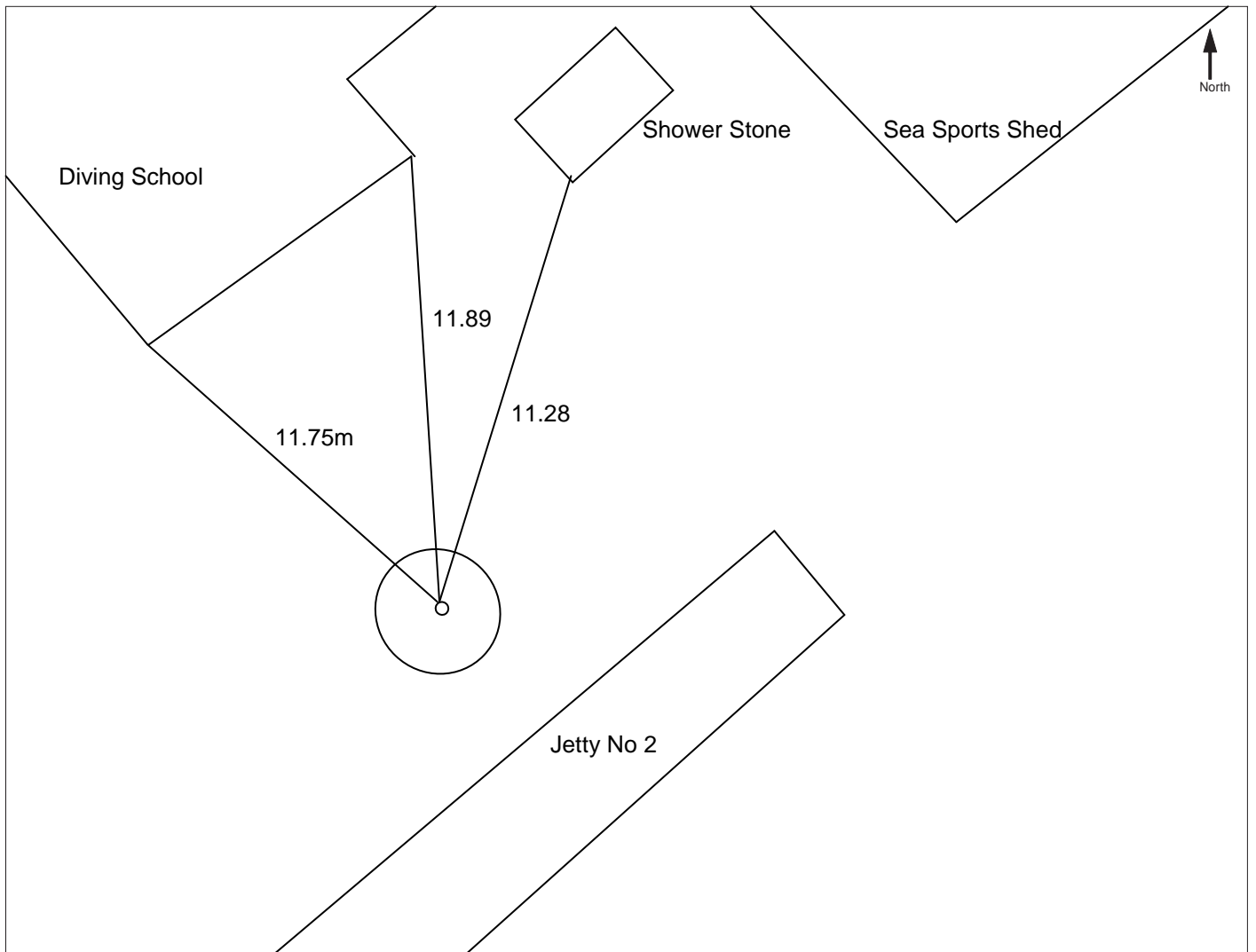
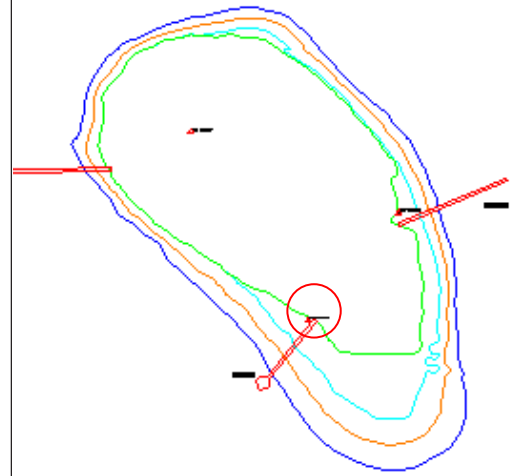

Sketched by: Ahmed Nuaim

Scale: Not to scale

Date: 05/06/2012

SURVEY UNIT,

MINISTRY OF HOUSING AND ENVIRONMENT
Ameenee Magu, Maafannu, Male', 20392, Maldives.
Office (PABX): +(960) 3004300, Fax: +(960) 3004301
Email: survey@mhe.gov.mv
Web: www.mhe.gov.mv



CONTROL POINT DETAILS	Station Number PSM5026
Coordinate Information	
Geodetic	Grid
WGS 84	UTM Zone 43
Lat:	E: 258005.368 m
Long:	N: 404046.011 m
Ellp Height:	Orth Height: + 2.379 m
Date: 05/06/2012	

Monument description & method of survey:

Type A monument above ground, Closed Loop Traverse Method using coordinates.

General site condition & access:

Good access, in North side of Island, in-between tennis court and Volley court

Owner: Angaga Island resort and Spa



SITE INFORMATION

Station Number

P	S	M	5	0	2	6
---	---	---	---	---	---	---

Station Horizon Mask

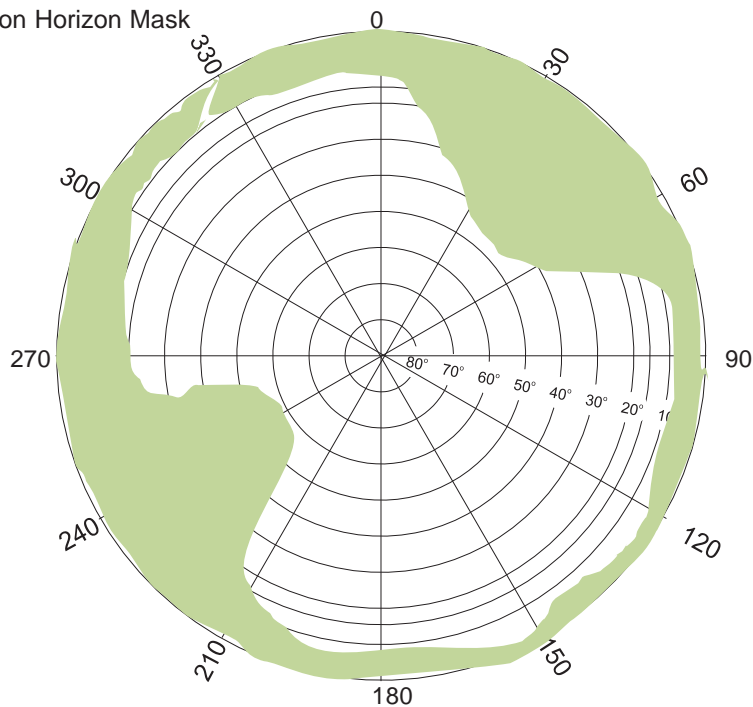

Height above Marker that horizon was mapped from 1.45 m

Magnetic Declination -----
 Declination applied to this figure?
 Yes No



Locality

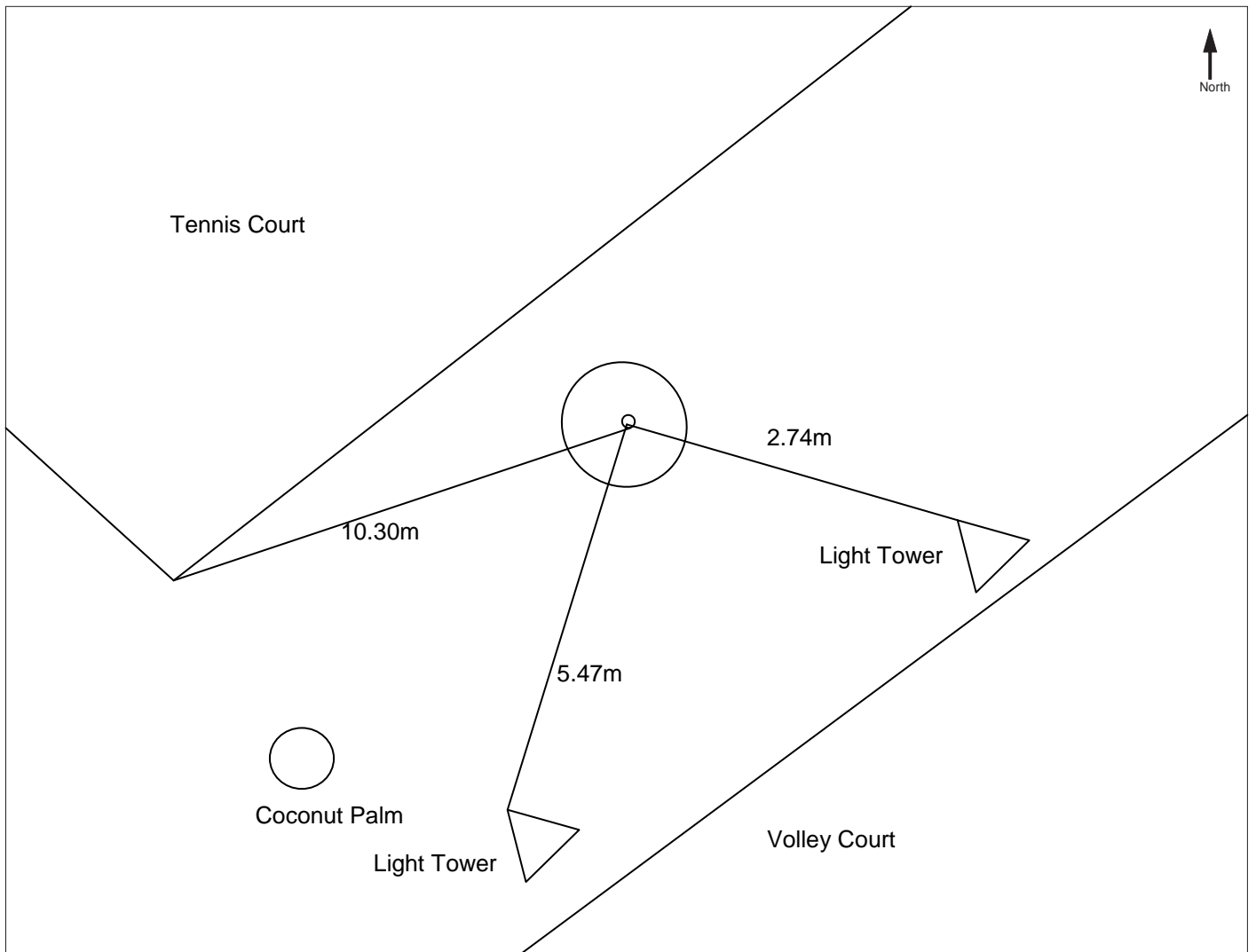
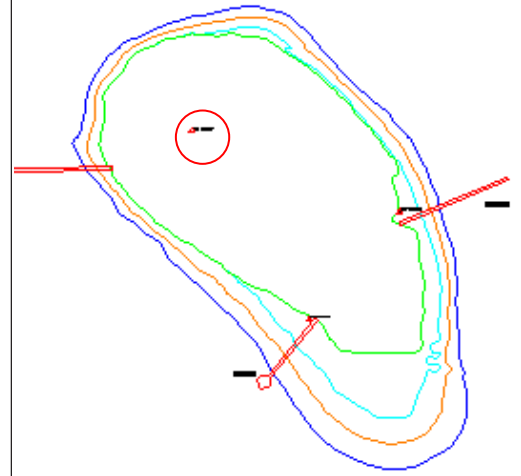

Sketched by: Ahmed Nuaim

Scale: Not to scale

Date: 05/06/2012

SURVEY UNIT,

MINISTRY OF HOUSING AND ENVIRONMENT
Ameenee Magu, Maafannu, Male', 20392, Maldives.
Office (PABX): +(960) 3004300, Fax: +(960) 3004301
Email: survey@mhe.gov.mv
Web: www.mhe.gov.mv



CONTROL POINT DETAILS	Station Number PSM5027
Coordinate Information	
Geodetic	Grid
WGS 84	UTM Zone 43
Lat: N3°39'08.49499"	E: 258140.461 m
Long: E72°49'21.35617"	N: 403993.838 m
Ellp Height: -87.078	Orth Height: + 1.465 m
Date: 05/06/2012	

Monument description & method of survey:

Type A monument buried below ground, GPS Static Point fixing method

General site condition & access:

Good access, in East side of Island, near main access jetty

Owner: Angaga Island resort and Spa



SITE INFORMATION

Station Number

P	S	M	5	0	2	7
---	---	---	---	---	---	---

Station Horizon Mask

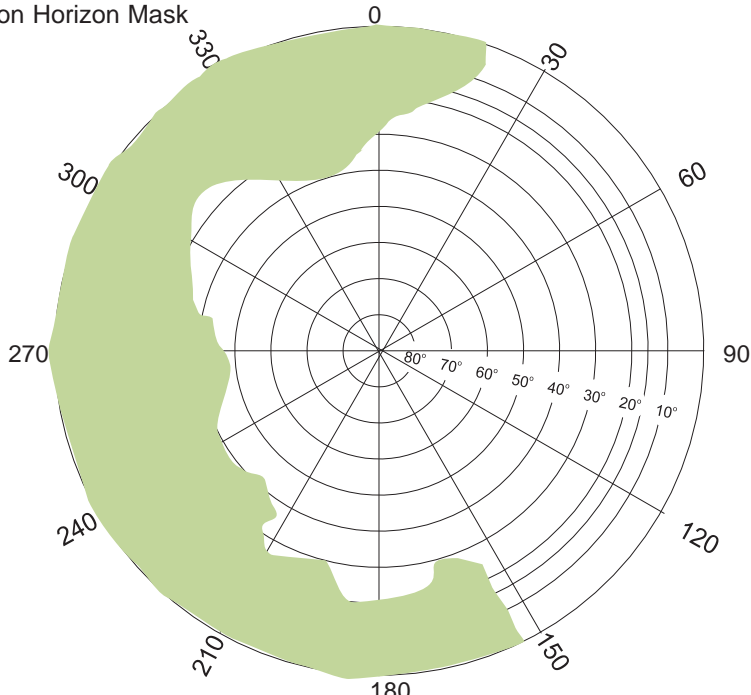

Height above Marker that horizon was mapped from 1.45 m

Magnetic Declination -----
 Declination applied to this figure?
 Yes No



Locality

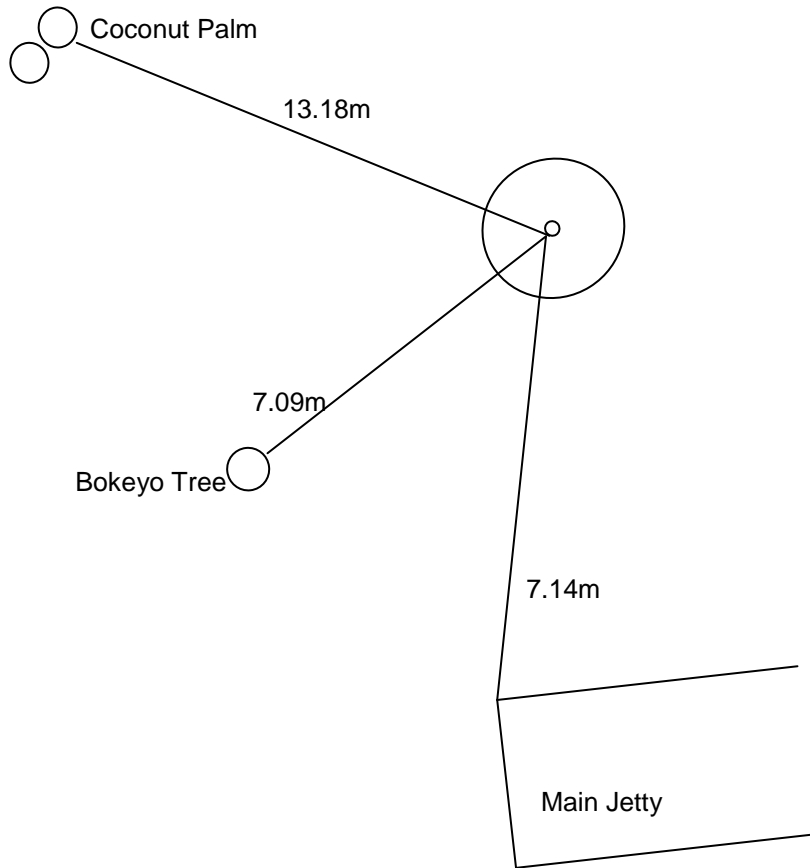
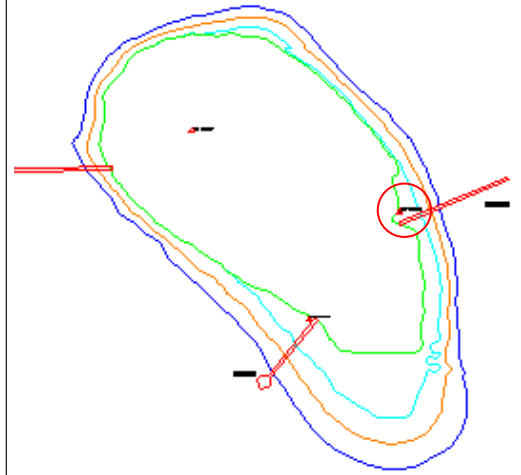

Sketched by: Ahmed Nuaim

Scale: Not to scale

Date: 05/06/2012

SURVEY UNIT,

MINISTRY OF HOUSING AND ENVIRONMENT
Ameenee Magu, Maafannu, Male', 20392, Maldives.
Office (PABX): +(960) 3004300, Fax: +(960) 3004301
Email: survey@mhe.gov.mv
Web: www.mhe.gov.mv



CONTROL POINT DETAILS	Station Number BM1
Coordinate Information	
Geodetic	Grid
WGS 84	UTM Zone 43
Lat:	E: 258102.4330 m
Long:	N: 403905.3938 m
Ellp Height:	Orth Height: +1.756 m
Date: 24/12/2012	

Monument description & method of survey:

Type A monument above ground, close loop traverse method using coordinates

General site condition & access:

Good access, in South West side of Island, behind the main restaurant facing the beach.

Owner: Angaga Island resort and Spa



SITE INFORMATION

Station Number

B	M	1					
---	---	---	--	--	--	--	--

Station Horizon Mask

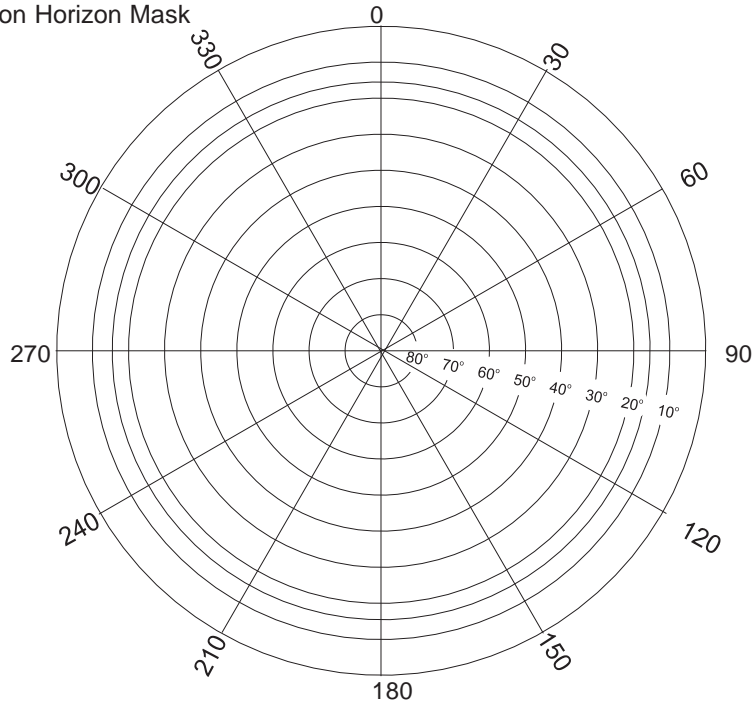

Height above Marker that horizon was mapped from 1.45 m

Magnetic Declination -----
Declination applied to this figure?
 Yes No



Locality

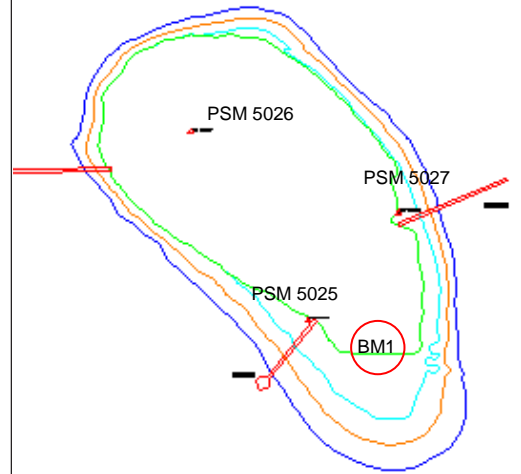

Main Restaurant



Tree

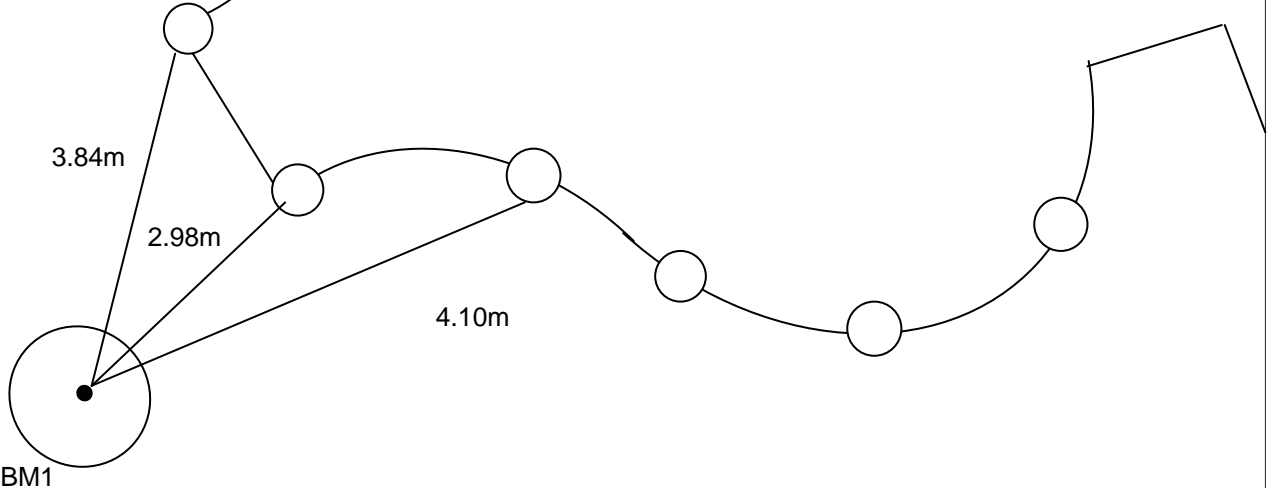

* All measurements are taken from the column

Sketched by: Ahmed Nuaim

Scale: Not to scale

Date: 24/12/2012